

**iwata** *studio series*

**SPRINT JET IS-800**

**AIR COMPRESSOR**



**IWATA STUDIO SERIES SPRINT JET AIR COMPRESSOR — IS-800**

*Congratulations on your new purchase! The Iwata Sprint Jet Air Compressor delivers quiet, clean, pulse free air along with superb moisture separation and precise air pressure adjustment.*



# ASSEMBLY INSTRUCTIONS

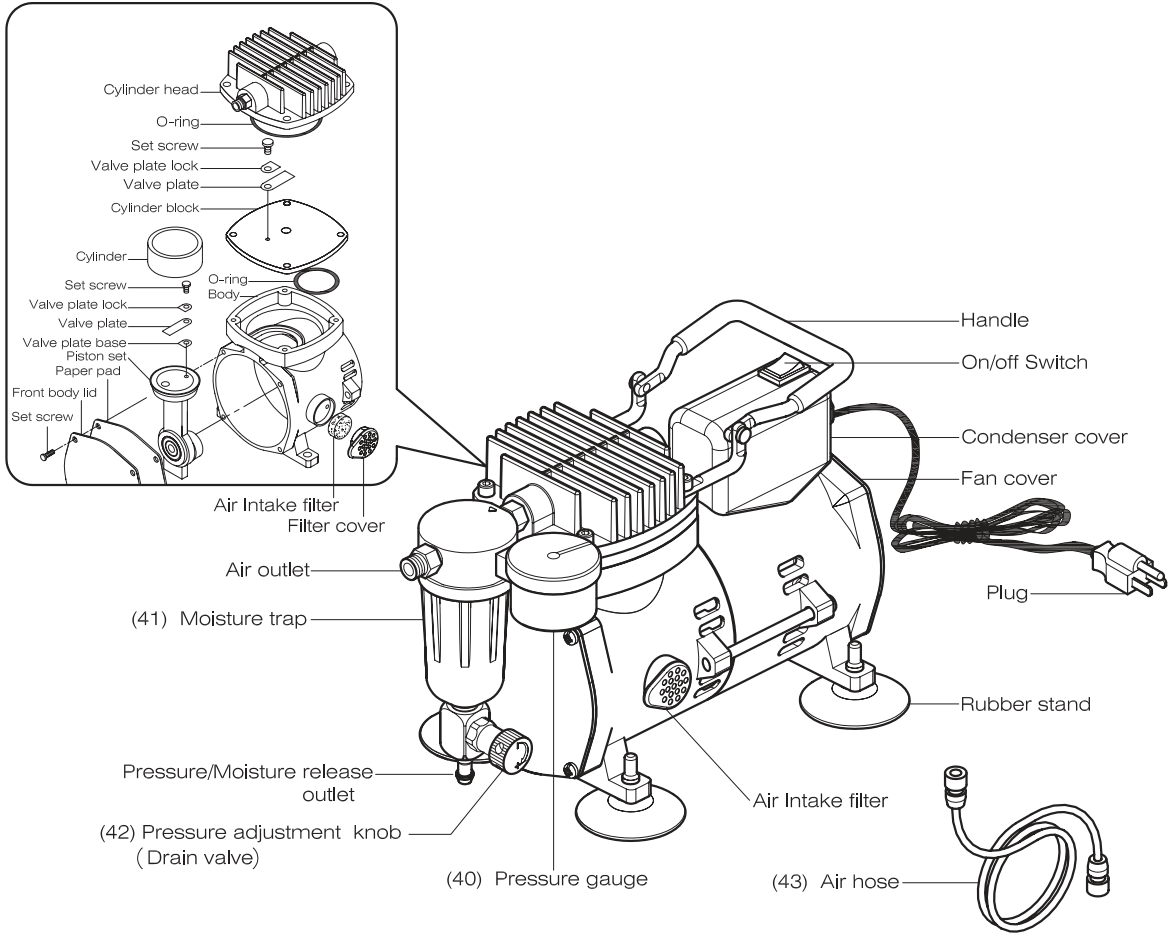

1. Unpack the compressor and all packaged components. Enclosed you'll find:
  - a. Sprint Jet Compressor (#IS 800)
  - b. Straight Airhose (#DT I 10)
  - c. Adapter Kit (for other brands of airbrush)
  - d. Sprint Jet Manual
  - e. Sprint Jet Parts Diagram
  
2. Screw the straight air hose's big end onto the moisture trap's big screw.
  
3. Screw the straight air hose's small end onto the airbrush
  - a. Note: If you're using a brand of airbrush other than Iwata, use the appropriate adapter from the adapter kit. You might have to try them out to see which one is right.

4. Plug the compressor into a grounded wall outlet. (Avoid using an extension cord.)
5. Turn the compressor ON by pressing down the switch on top of the unit.
6. As the unit is being used, water may collect in the moisture trap's clear, plastic bowl.
7. Release the water by twisting the dial toward the “–” sign while the unit is turned on.
  - a. This will open the bleed valve and drain off the collected moisture.
  - b. Do not let excess water build up in the moisture trap.
  - c. Hold a paper towel under the open valve to collect the water.
  - d. Once water is drained, close the bleed valve before using the compressor again.

1. When you first hook up your airbrush to your compressor, turn it on and depress the trigger of your airbrush, the pressure that registers on your gauge is called your “working pressure.” Your working pressure can vary depending on the size of your airbrush’s nozzle. The smaller the nozzle size, the higher your working pressure. An average nozzle size of 0.3mm will expend a working pressure of approximately 25-28 psi with the Sprint Jet.
2. You cannot increase your working pressure, but you can decrease your working pressure by using the air adjustment knob to open the bleed valve.
3. Adjust the air pressure by turning the air adjustment knob toward the + or – while spraying air from the airbrush.
4. When you want to go back to your “working pressure” be sure to close your bleed valve all the way (toward the “+”).

### Releasing Built Up Moisture

- Release the water by twisting the dial toward the – sign.
- This will open the bleed valve and drain off the collected moisture.
- Hold a paper towel under the open valve to collect the water.
- Do not let excess water build up in the moisture trap.

### Changing The Air Filter

The filter only needs to be changed if it's significantly dirty or dirty enough to cut air flow into the compressor.

- Use your finger to pull the black tab out
- Pull out the sponge-like air-filter
- Replace with new air filter (Part # IS 030 – 10 pack)
- Please inspect your air filter once per week with heavy compressor use.

*DO NOT use oil in/on the compressor.*

## ENDING A SESSION

1. Release any built up moisture.
2. Turn off the compressor.
3. Release any leftover air.

For any other problems or issues call or contact Iwata-Medea at 503-253-7308 or email us at: [info@medea-artool.com](mailto:info@medea-artool.com).

**Oil-Less Piston Compressor**

Oil-less means oil-less! The compressor uses PTFE gaskets to seal the compression chamber. This allows the compressor to be quiet without atomizing oil into the air stream, which makes the compressor virtually maintenance free.

**Air Pressure Adjustment Knob**

Though not a full regulator, the air pressure adjustment knob allows control of the air pressure. It also doubles as the moisture release valve.

**Moisture Trap Assembly**

The moisture trap filters out the water and debris down to 5 microns.

**Air Pressure Gauge**

Don't guess what pressure you're spraying at! Know it! Your "working pressure" (or "working psi") is what the gauge shows while you have your trigger pressed down.

**Power Switch**

Yes, it's a feature! You don't have to unplug the compressor when you want it to stop, just flip the switch.

**Thermal Overload Switch**

If the compressor ever decides to overheat, the Thermal Overload Switch will turn off your compressor. If this switch cuts in it's saving your compressor. Let it cool down. The switch will automatically reset itself.

**Voltage**

If you bought the compressor in the country you're going to use it, it's completely ready to go. If you're going to transfer the compressor to another country with a different voltage, the unit won't accommodate the new voltage by flipping a switch; you'll need a plug adapter and the appropriate power converter. These items typically are found at hardware stores or electronic stores.

## WARRANTY

All Iwata compressors are *Warranted* against all manufacturing defects of material and manufacture or workmanship for a period of ONE year from the date of purchase\*. Any part or material that is or becomes defective so as not to be usable within this period will be repaired or replaced. This warranty does not cover damage caused by negligence or a compressor that has been altered or abused in any way.

Call or email Iwata-Medea before returning a compressor for the appropriate procedure for warranty repairs. Any material that is shipped to Iwata-Medea without prior authorization will not be accepted.

- Telephone Technical Support: Iwata-Medea offers technical support over the phone at no charge. Telephone support includes general usage information, cleaning tips, and troubleshooting.
- For Tech Support please call us at 503-253-7308 Pacific Time, 9am – 12pm & 1pm – 4pm, Monday – Friday
- NOTE: All compressors returned for repair must have a Return Authorization Number. Please call 503-253-7308 to obtain an RA number, instructions, and our shipping address.

Warranty service will be provided only at authorized Iwata-Medea service centers. You must pay all charges for shipping/transporting your Iwata Studio Series Compressor to/from these service facilities.

*Iwata-Medea, Inc will not be responsible for damage to persons or property, commercial loss or any other incidental or consequential damage caused by a defective compressor. However, some states do not allow the exclusion or limitation of incidental or consequential damages, so the above limitations may not apply to you.*

*All implied warranties, including any warranty of merchantability or fitness are limited to the duration of this written warranty. However, some states do not allow limitations on how long an implied warranty lasts, so the above limitation may not apply to you.*

\* Please keep the sales receipt.

*Genuine Iwata*



— W W W . I W A T A A I R B R U S H . c o m —

**Iwata-Medea, Inc.** • 1336 N. Mason St. • Portland, Oregon 97217

tel: (503) 253-7308 • fax: (503) 253-0721 • [info@iwata-medea.com](mailto:info@iwata-medea.com)